

Small Signal Zener Diode

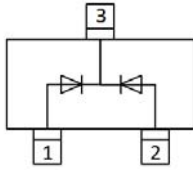

SOT-23

Features

- Epoxy meets UL-94 V-0 flammability rating and halogen free
- Moisture Sensitivity Level 1
- Zener Voltage 2.4V~47V
- V_z -tolerance for both diodes in one case is $\leq 5\%$
- Part no. with suffix "Q" means AEC-Q101 qualified

Applications

- General regulation functions

Mechanical Data

- **Case:** SOT-23
- **Terminals:** Tin plated leads, solderable per J-STD-002 and JESD22-B102

■ Limiting Values (Absolute Maximum Rating, $T_a=25^\circ\text{C}$ Unless otherwise specified)

Characteristic	Symbol	Value	Units
Power Dissipation	$P_{D[1]}$	300	mW
Maximum Forward Voltage ($I_F=10\text{mA}$)	V_F	0.9	V
Maximum Regulator Current	$I_{ZM[1]}$	P_D / V_z	mA
Thermal Resistance from Junction to Ambient	$R_{\theta JA}$	417	$^\circ\text{C} / \text{W}$
Storage Temperature Range	T_{STG}	-55~+150	$^\circ\text{C}$
Operation Temperature	T_J	-55~+150	$^\circ\text{C}$

[1] Single diode loaded

■ Ordering Information (Example)

PREFERRED P/N	PACKING CODE	UNIT WEIGHT(g)	MINIMUM PACKAGE(pcs)	INNER BOX QUANTITY(pcs)	OUTER CARTON QUANTITY(pcs)	DELIVERY MODE
DZ23C2V4Q THRU DZ23C47Q	F2	Approximate 0.01	3000	30000	120000	7" reel



DZ23C2V4Q THRU DZ23C47Q

■Electrical Characteristics (T_a=25°C Unless otherwise specified)

Type Number	Device Marking	V _z at I _{zt} (V)			I _{zt} mA	Z _{zt} (Ω)		Z _{zk} (Ω)		I _R (μA)@V _R		Typical Temperature Coefficient@ I _{ZTC} mV/°C		Test Current I _{ZTC} mA
		min.	typ.	max.		I _{zt} (mA)	max.	I _{zk} (mA)	max.	uA	V _R (V)	Min	Max	
DZ23C2V4Q	V0	2.28	2.4	2.56	5	5	100	1.0	600	50	1.0	-3.5	0	5
DZ23C2V7Q	KV1	2.5	2.7	2.9	5	5	100	1.0	600	20	1.0	-3.5	0	5
DZ23C3V0Q	KV2	2.8	3.0	3.2	5	5	95	1.0	600	10	1.0	-3.5	0	5
DZ23C3V3Q	KV3	3.1	3.3	3.5	5	5	95	1.0	600	5	1.0	-3.5	0	5
DZ23C3V6Q	KV4	3.4	3.6	3.8	5	5	90	1.0	600	5	1.0	-3.5	0	5
DZ23C3V9Q	KV5	3.7	3.9	4.1	5	5	90	1.0	600	3	1.0	-3.5	0	5
DZ23C4V3Q	KV6	4.0	4.3	4.6	5	5	90	1.0	600	3	1.0	-3.5	0	5
DZ23C4V7Q	KV7	4.4	4.7	5.0	5	5	80	1.0	500	3	2.0	-3.5	0.2	5
DZ23C5V1Q	KV8	4.8	5.1	5.4	5	5	60	1.0	480	2	2.0	-2.7	1.2	5
DZ23C5V6Q	KV9	5.2	5.6	6.0	5	5	40	1.0	400	1	2.0	-2	2.5	5
DZ23C6V2Q	KVA	5.8	6.2	6.6	5	5	10	1.0	150	3	4.0	0.4	3.7	5
DZ23C6V8Q	KVB	6.4	6.8	7.2	5	5	15	1.0	80	2	4.0	1.2	4.5	5
DZ23C7V5Q	KVC	7.0	7.5	7.9	5	5	15	1.0	80	1	5.0	2.5	5.3	5
DZ23C8V2Q	KVD	7.7	8.2	8.7	5	5	15	1.0	80	0.7	5.0	3.2	6.2	5
DZ23C9V1Q	KVE	8.5	9.1	9.6	5	5	15	1.0	100	0.5	6.0	3.8	7.0	5
DZ23C10Q	KVF	9.4	10	10.6	5	5	20	1.0	150	0.2	7.0	4.5	8.0	5
DZ23C11Q	KVG	10.4	11	11.6	5	5	20	1.0	150	0.1	8.0	5.4	9.0	5
DZ23C12Q	KVH	11.4	12	12.7	5	5	25	1.0	150	0.1	8.0	6.0	10.0	5
DZ23C13Q	KVI	12.4	13	14.1	5	5	30	1.0	170	0.1	8.0	7.0	11.0	5
DZ23C15Q	KVJ	13.8	15	15.6	5	5	30	1.0	200	0.1	10.5	9.2	13.0	5
DZ23C16Q	KVK	15.3	16	17.1	5	5	40	1.0	200	0.1	11.2	10.4	14.0	5
DZ23C18Q	KVL	16.8	18	19.1	5	5	45	1.0	225	0.1	12.6	12.4	16.0	5
DZ23C20Q	KVM	18.8	20	21.2	5	5	55	1.0	225	0.1	14.0	14.4	18.0	5
DZ23C22Q	KVN	20.8	22	23.3	5	5	55	1.0	250	0.1	15.4	16.4	20.0	5
DZ23C24Q	KVO	22.8	24	25.6	5	5	70	1.0	250	0.1	16.8	18.4	22.0	5
DZ23C27Q	KVP	25.1	27	28.9	2	2	80	0.5	300	0.1	18.9	21.4	25.3	2
DZ23C30Q	KVQ	28	30	32	2	2	80	0.5	300	0.1	21.0	24.4	29.4	2
DZ23C33Q	KVR	31	33	35	2	2	80	0.5	325	0.1	23.1	27.4	33.4	2
DZ23C36Q	KVS	34	36	38	2	2	90	0.5	350	0.1	25.2	30.4	37.4	2
DZ23C39Q	KVT	37	39	41	2	2	130	0.5	350	0.1	27.3	33.4	41.2	2
DZ23C43Q	KVU	40	43	46	2	2	100	0.5	700	0.1	32	37.6	50.6	2
DZ23C47Q	KVV	44	47	50	2	2	100	0.5	750	0.1	35	42.0	55.8	2



DZ23C2V4Q THRU DZ23C47Q

■ Characteristics(Typical)

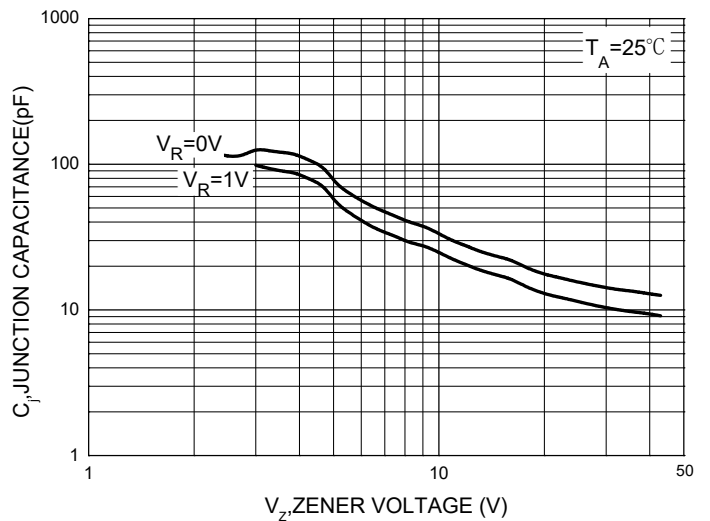
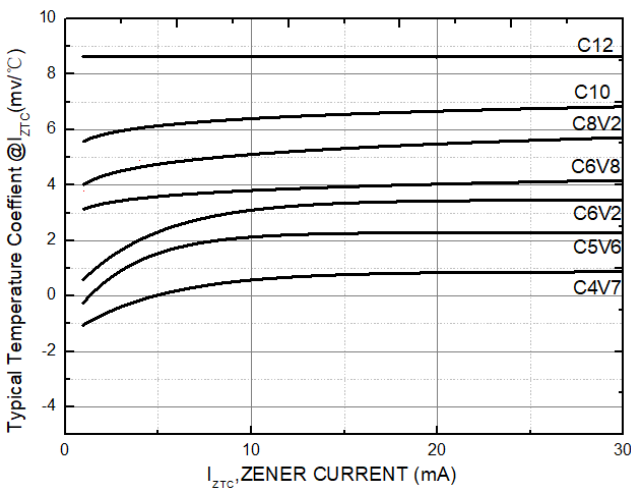
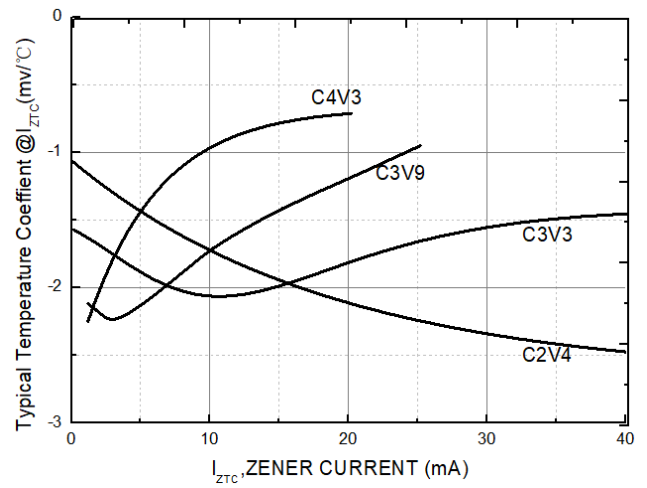
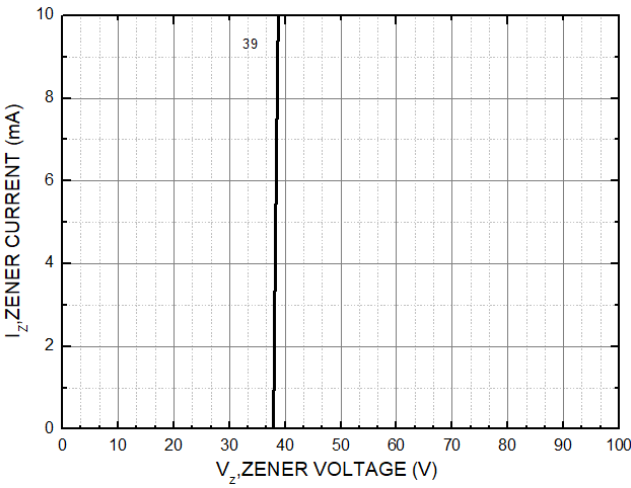
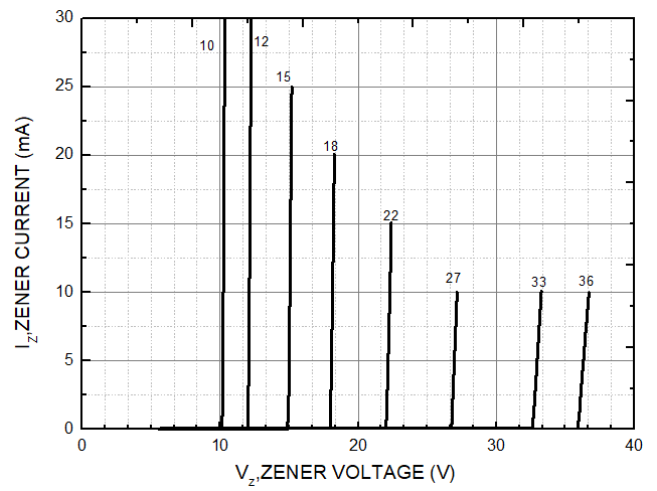
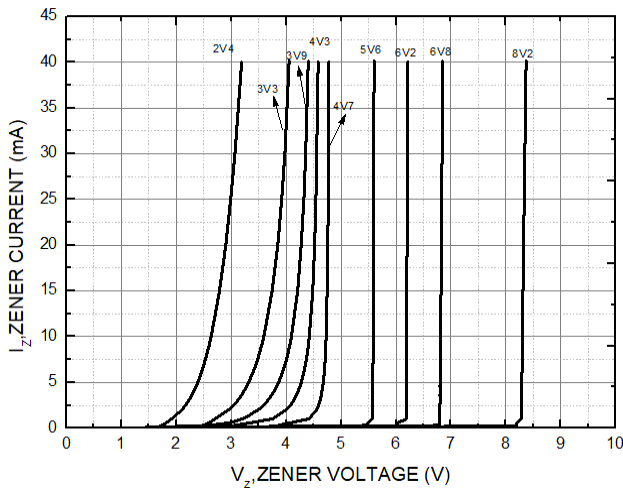



DZ23C2V4Q THRU DZ23C47Q

■ Outline Dimensions

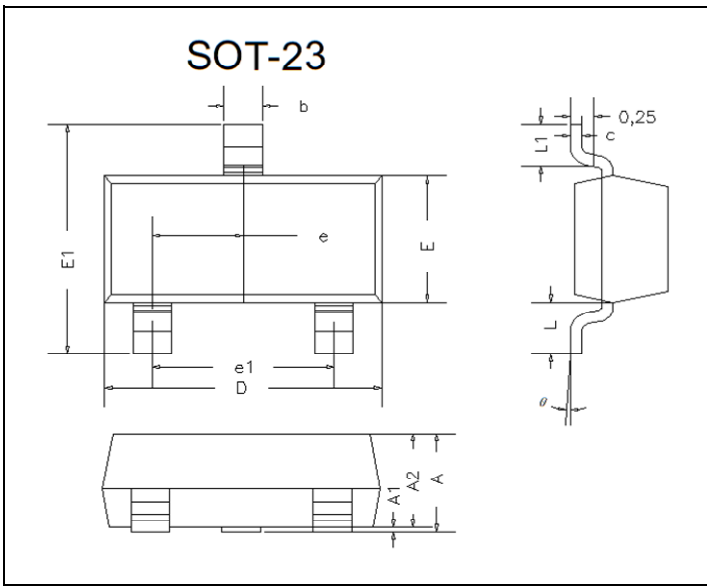

DIM	INCHES		MM		NOTE
	MIN	MAX	MIN	MAX	
A	0.035	0.045	0.90	1.15	
A1	0.000	0.004	0.00	0.10	
A2	0.035	0.041	0.90	1.05	
b	0.012	0.020	0.30	0.50	
c	0.004	0.008	0.10	0.20	
D	0.110	0.118	2.80	3.00	
E	0.047	0.055	1.20	1.40	
E1	0.089	0.100	2.25	2.55	
e	0.370TYP		0.95TYP		
e1	0.071	0.079	1.80	2.00	
L	0.220REF		0.55REF		
L1	0.012	0.020	0.30	0.50	
θ	0°	8°	0°	8°	

■ Soldering Footprint

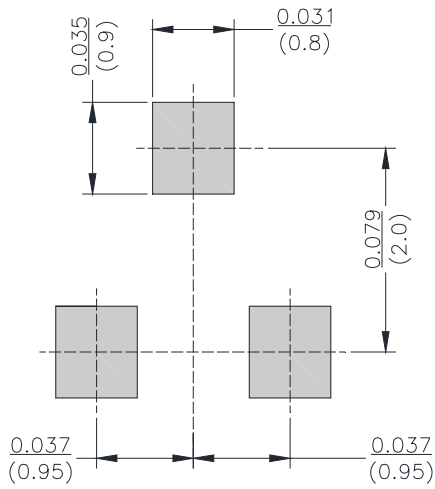

Unit: $\frac{\text{inch}}{\text{mm}}$



DZ23C2V4Q THRU DZ23C47Q

Disclaimer

The information presented in this document is for reference only. Yangzhou Yangjie Electronic Technology Co., Ltd. reserves the right to make changes without notice for the specification of the products displayed herein to improve reliability, function or design or otherwise.

The product listed herein is designed to be used with automotive electronics, are not designed for use in medical, life-saving, lifesustaining, or military, Yangjie or anyone on its behalf, assumes no responsibility or liability for any damages resulting from such improper use of sale.

This publication supersedes & replaces all information previously supplied. For additional information, please visit our website [http:// www.21yangjie.com](http://www.21yangjie.com) , or consult your nearest Yangjie's sales office for further assistance.